

COAST

PORT BEACH



welcome to coast

Thank you for considering Coast as the venue for your flawless event. At our beachside venue, we like to make things a breeze and our team is here to ensure you have a stunning night!

Enjoy panoramic ocean views in a relaxed, welcoming atmosphere – the perfect beachside location for the most special days. Our venue is located as close to the Indian Ocean as you could be without getting your toes wet.

We offer the full package – picturesque views both inside the venue and out, artisanal and local WA products, and a no-fuss approach to planning.

Let Coast be the backdrop for your event to remember!

Thank you,

The Coast Team ☀

SUSTAINABILITY Coast is unique in that our venue is built around environmental sustainability. We use no single-use plastics, are fully solar-powered and recycle or compost what minimal waste we do create. Our menus are built around fresh and seasonal ingredients from local Western Australia purveyors with a beverage selection to match.



inclusions

AV/MUSIC

- In-house state of the art soundsystem
- External music capabilities: DJ decks and speakers
- Small staging for keynote speaking, DJs, or performers
- Festoon lighting and in-house lighting of venue

SECURITY/CROWD CONTROL

- Security fencing and barricades
- Bar queue fencing for each bar
- Approved Managers on staff and Covid Officers
- Option to hire security team

DÉCOR and FURNITURE

- Faux grass carpeting in venue and for carpark or extended areas
- Use of cocktail-height tables & rounds, stools, low tables & chairs, couches and lounge seating
- Beach lounges and tables, umbrellas
- Salvaged and repurposed marine décor
- Extensive live plants and gardens

areas & floor maps



Capacity: 1100 total in venue / 2000+ with
beach and carpark extension*

BOATHOUSE: 320 sqm / 200 persons

*additional fees and permitting required

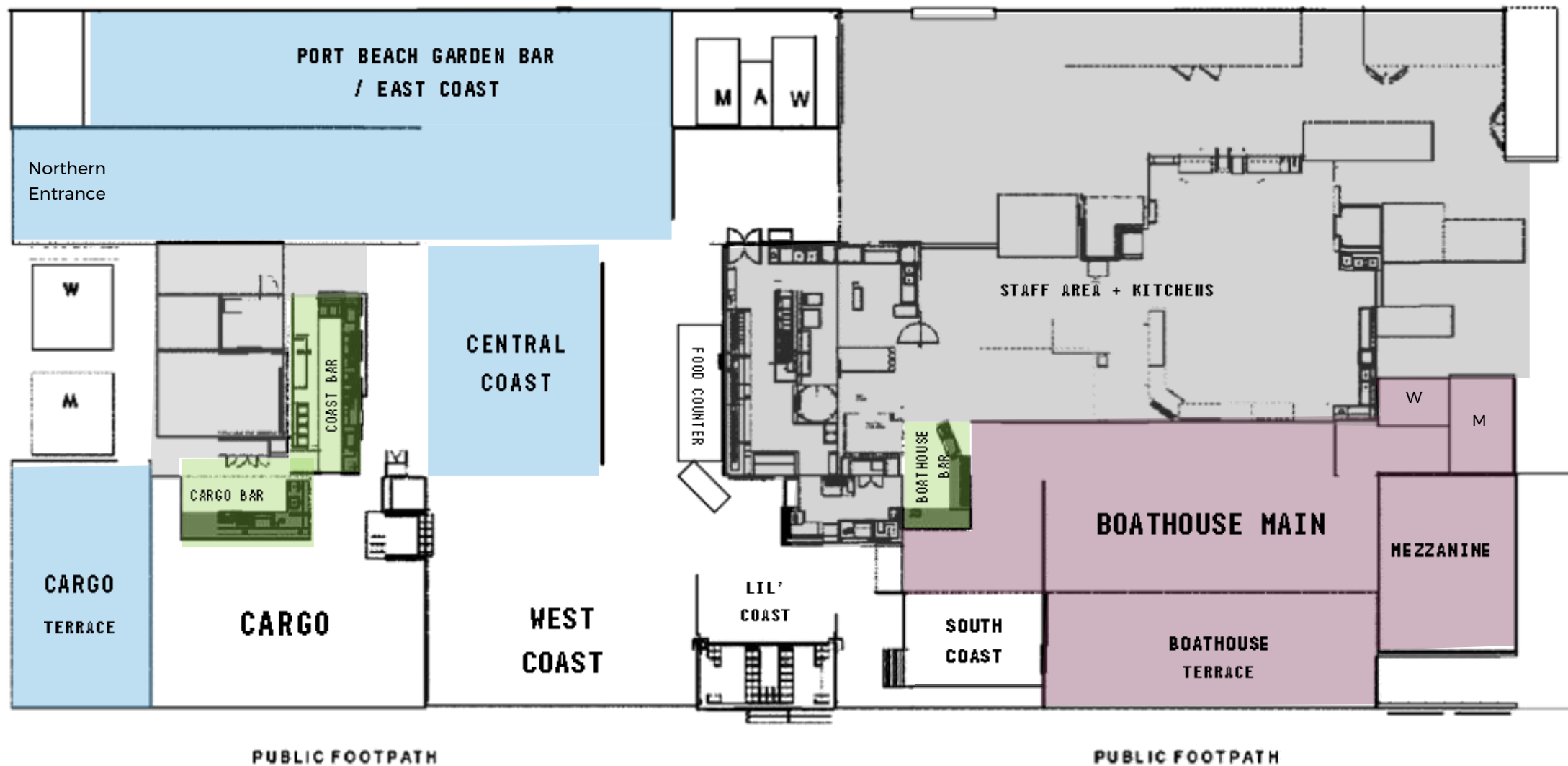

the beach

This unique option to extend functions to Port Beach is a once-in-a-million opportunity for events! The view and experience is unmatched.

Whether there are remote can bars, a beach BBQ, or a DJ— the beach has all the options to bring any ideas to life.

(1500 event capacity minimum. Major terms apply— chat with our event team to explore the possibilities)



Located in the North West of Coast, Cargo Bar is the most popular space within our venue, especially during summertime.

Features: Indoor and Outdoor Area, full sweeping views of ocean. Included Full Bar, men's and women's toilets

Total Area Size: 180 sqm

Cocktail (entire): up to 150 persons

Cocktail (inside): 20-80 persons

Cocktail (outdoor terrace): 40-70 persons



cargo bar & terrace

west coast

With uninterrupted views of the Indian Ocean, West Coast is a great space for a cocktail events, a dancefloor for killer DJs, or staging for keynote speakers.

Features: Full sweeping views of ocean. area for low or high cocktail seating. high ceilings for staging, lighting, and sound requirements.

Total Area Size: 120 sqm

Cocktail: up to 100 persons

Seated: up to 80 persons



central coast

Get the best of both worlds, with high tables and cocktail crowd areas, both garden and sea attributes, and an indoor-outdoor area!

Features: Garden outdoor setting, option for high cocktail seating or space for crowds, dancefloors or performances. Attached bar with high volume capacity. Indoor/outdoor setting

Total Area Size: 120 sqm

Cocktail: up to 100 persons

Seated: up to 80 persons



garden bar & east coast

This unique & intimate space offers an earthy and relaxed feel with couches, a lush garden, and marine artwork perfect for photo-snapping opportunities. A small pop-up bar can be arranged for easy access or this area can be utilized as complex staging for a performer or DJ.

Features: Lush garden outdoor setting, Optional satellite bar set-up. Area for performer staging, DJ set up, or keynote presentation.

Total Area Size: 150 sqm

Cocktail: up to 150 persons





This elevated secluded deck is a great space for VIPs to gather, a secluded lounge area for attendees, or a demo area for breakout presentations.

Features: Gorgeous wood decking and uninterrupted views of the coastline,

Total Area Size: 40 sqm

Cocktail: up to 25 persons

Seated: 20 persons



south coast

the boathouse

With a rustic and beachy feel, the Boathouse offers panoramic views of the Indian ocean. Perfect space for large seated functions, cocktail events, breakout presentation sessions, or performances.

Features: Breathtaking view, farmhouse chic décor, plants and festoon lighting, private bar, attached men's and women's toilets

Total Area Size: 320 sqm

Quarterdeck (area 42sqm): 30 (seated) / 40 (cocktail)

Terrace (area 80sqm): 70 (seated) / 100 (cocktail)

Main Floor (area 200sqm): 90 (seated) / 150 (cocktail)



the kitchens

- Two full sized high-volume production satellite kitchens
- Plenty of prep space.
- The capacity to produce food for 2,500 people (based on previous festival events)
- The unique ability to cater on the beach without the need to hire remote catering equipment







COAST
PORT BEACH